

# DWARKA PROJECT

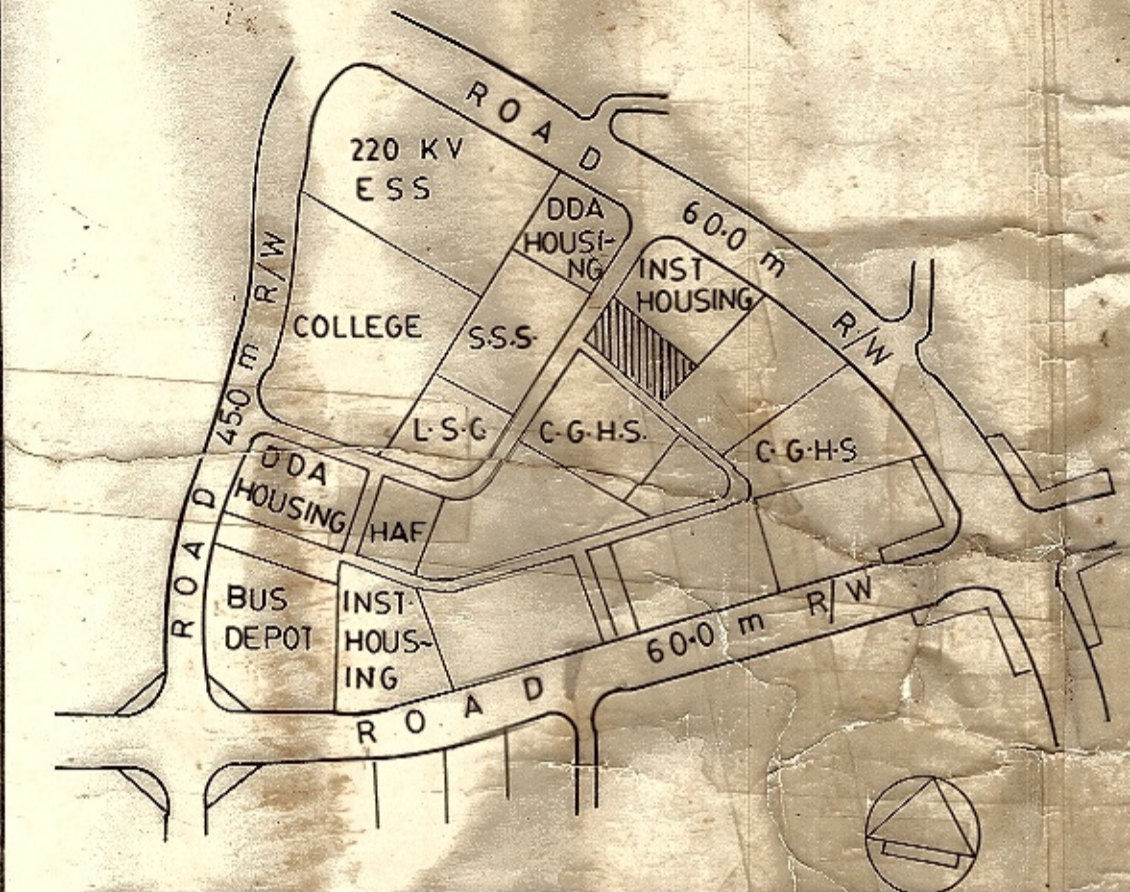
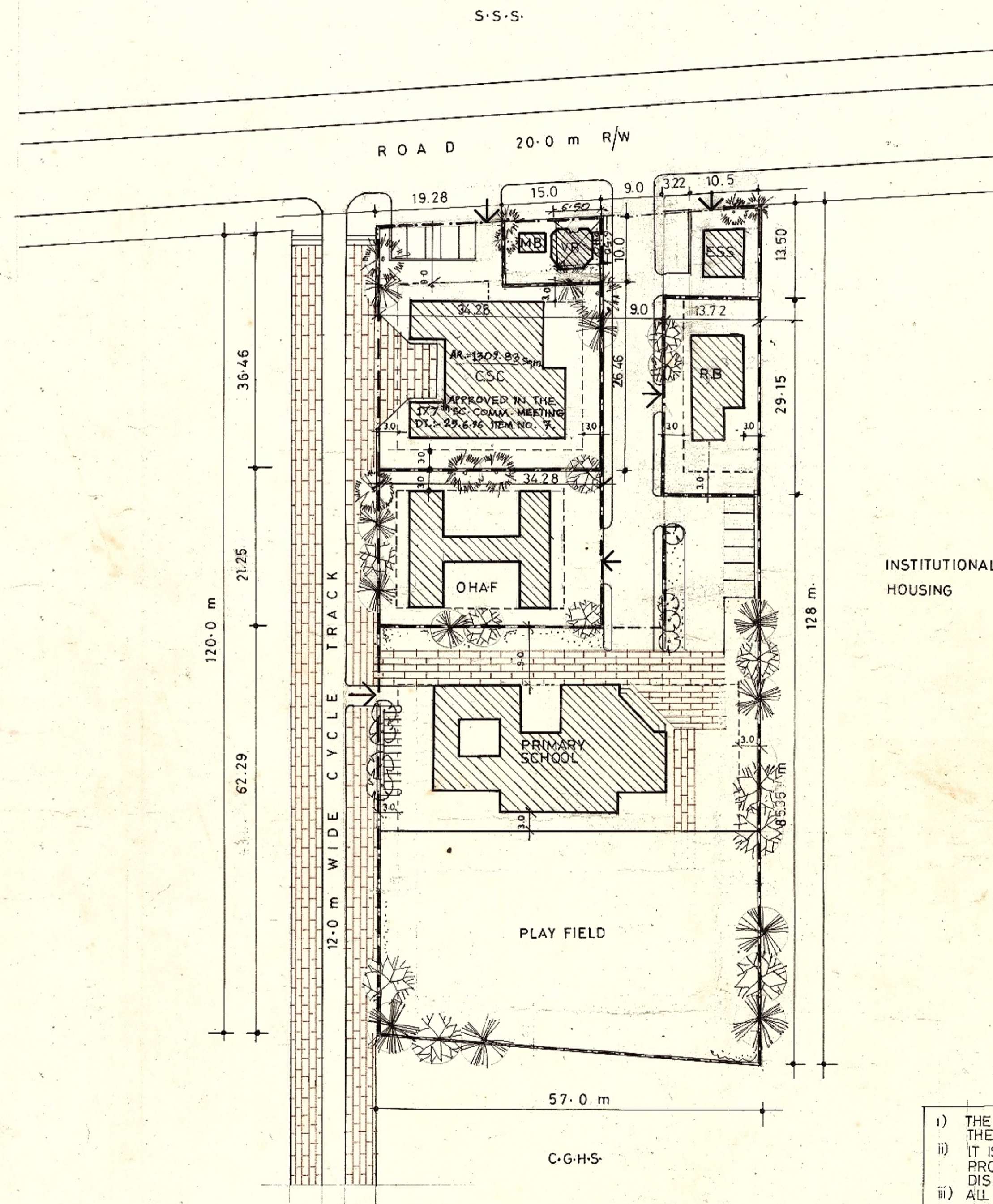

## KEY PLAN

### AREA STATEMENT

TOTAL AREA OF THE PLOT	7068.00 SQ. M.
PRIMARY SCHOOL	4000.86 SQ. M.
CONV. SHOPPING	1100.00 SQ. M.
MILK BOOTH	150.00 SQ. M.
O.H.A.F.	728.44 SQ. M.
RELIGIOUS	400.00 SQ. M.
CIRCULATION	546.93 SQ. M.
ESS	141.75 SQ. M.

	MAX GR. COVERAGE	FAR	MAX. HT.
PRIMARY SCHOOL	33%	100	14 mts
CON. SHOPPING	40%	60	8 mts
RELIGIOUS	33-33%	86-88	8 mts

LAYOUT APPROVED IN THE SCREENING COMMITTEE  
HELD ON DATED 19-10-93 ITEM NO. 96-93:131:SC.

## HOUSING AREA FACILITY

PLOT NO. II SECTOR. 2

- i) THE PLAN IS SUBJECT TO MODIFICATIONS WITHIN THE FRAMEWORK OF MASTER PLAN/ZONAL PLAN.
- ii) IT IS FOR PLANNING PURPOSE & IS NOT FIT TO BE PRODUCED IN THE COURT OF LAW FOR PROPERTY DISPUTES.
- iii) ALL THE DIMENSIONS & AREA GIVEN IN THE PLAN ARE SUBJECT TO CONFIRMATION OF OWNERSHIP/ALLOTMENT STATUS AND DEMARCATIONS/FEASIBILITY REPORT FROM THE DDA LANDS & ENGINEERING WING RESPECTIVELY.

### LAY OUT PLAN

		DRG. NO. 302/11
PLG. D MAN	PLG. ASSTT.	DATE
ASSTT. DIRECTOR	JOINT DIRECTOR	DIRECTOR PLG.